

IPC Shooting Rules and Regulations

2011-2012



May 2011



IPC SHOOTING RULES AND REGULATIONS

2011-2012

Note: These Rules and Regulations come into full force on 1 June 2011

TABLE OF CONTENTS

PREAMBLE	4
1 GENERAL	5
1.1 Printing of Rules and Regulations.....	5
1.2 Effect of ISSF Sport Technical Rules and Regulations.....	5
2 IPC SHOOTING REGULATIONS	6
2.1 IPC Shooting recognized competitions and Levels.....	6
2.2 Competition Cycle.....	6
2.3 Competition Management	6
2.4 Athletes Eligibility	7
2.5 Minimum Qualifying Standards	8
3 COMPETITION PROCESSES (PRIOR, DURING, AFTER)	9
3.1 General.....	9
3.2 Prior competition processes.....	9
3.3 During competition processes	10
3.4 After competition processes	11
4 PROCESSES FOR APPROVAL AND SANCTIONING OF IPC SHOOTING COMPETITIONS	14
4.1 Process for International Approved IPC Shooting Competitions.....	14
4.2 Process for World Cup (or Paralympic Qualifier) sanctioned IPC Shooting Competitions	14
5 IPC SHOOTING OFFICIALS	15
5.1 General.....	15
5.2 Duties and functions of Officials	16
5.3 Education, Certification and Development of Officials.....	17
6 SPECIAL CONDITIONS	19
6.1 Return to Field of Play Decisions	19
6.2 Epilepsy.....	19
7 IPC SHOOTING GENERAL RULES	20
7.1 Events and Programme of events.....	20
7.2 Equipment	21
7.3 Specifications class SH1	26
7.4 Specifications class SH2	28

7.5	Specifications class SH3	31
7.6	Sport Equipment Dimensions	31
7.7	Athlete's target changers for classes SH1 and/or SH2	31
7.8	Athlete's Loading Assistants for class SH2.....	31
8	IPC SHOOTING RIFLE RULES.....	32
8.1	Rifle Events and shooting times	32
9	IPC SHOOTING PISTOL RULES.....	34
9.1	Pistol Events and shooting times.....	34
9.2	Loading device (safety).....	34
9.3	Shooting position	34
10	RULES FOR SHOOTING FOR VISUALLY IMPAIRED ATHLETES	35
11	FALLING TARGETS RULES	36
11.1	Competition Format.....	36
11.2	Competition Commands.....	36
11.3	Results.....	37
12	TEAM COMPETITION.....	38



PREAMBLE

These IPC Shooting Rules and Regulations are mandatory for all IPC Shooting recognised competition. The overall governance and management of all IPC Sports (including IPC Shooting) is subject to the detailed provisions of Chapter 2.7 of the IPC Handbook.

Changes to these Rules and Regulations

Please note that these rules may be changed at any time as a result, for example, of changes in the ISSF rules, or classification related matters or where IPC Shooting otherwise considers it necessary to do so.

Changes may therefore be effective before 2012 and proper notice of any changes will be given.

1 GENERAL

1.1 Printing of Rules and Regulations

All rules of IPC Shooting are the copyright property of the IPC and have been published for the benefit of NPCs, athletes, officials and others who are engaged in an official capacity with IPC Shooting. These rules and regulations may be reprinted or translated by any organisation with a legitimate need to do so, subject to IPC's continuing ability to assert its copyright in the rules and regulations, including the right to insist on an assignment to the IPC of the copyright in any translated version of these rules and regulations. The English version of these rules and regulations shall be accepted as the authoritative version for the purpose of interpretation.

1.2 Effect of ISSF Sport Technical Rules and Regulations

The ISSF Sport technical rules shall be in force except where they are modified by the IPC Shooting rules and regulations. The ISSF rules are reinforced and not inserted or restated here and the rules and regulations of IPC Shooting are to be read in conjunction with the ISSF rules.

2 IPC SHOOTING REGULATIONS

2.1 IPC Shooting recognized competitions and Levels

IPC Shooting Recognized Competitions include:

- a) IPC Competitions (Paralympic Games, IPC Shooting World Championships, IPC Shooting Regional Championships)
- b) IPC Sanctioned Competitions (World Cup and/or World Cup “Paralympic Qualifiers”)
- c) IPC Shooting Approved Competitions (International shooting competitions endorsed by an NPC).

The designation of competitions is available in Appendix 1

IPC Shooting competition levels are as follows:

Level 3: IPC Competitions (Paralympic Games, World and Regional Championships)

Level 2: Sanctioned Competitions (World Cups or World Cups “Paralympic Qualifier”)

Level 1: Approved Competitions (International)

2.2 Competition Cycle

A 4-year-cycle for Championships will be adopted as follows:

- Year 1: Regional Championships (except if included in Regional Games)
- Year 2: World Championships
- Year 3: Regional Championships (except if included in Regional Games)
- Year 4: Paralympic Games

2.3 Competition Management

- a) IPC Shooting alone shall have the right to manage World Championships and sanctioned competitions. The words World and IPC Shooting may not be used in connection with any shooting event without the consent of IPC Shooting.
- b) IPC Shooting is empowered to formulate all rules and regulations for the conduct of such competitions.
- c) IPC Shooting shall have jurisdiction over all matters not assigned by the rules to the referees, or other officials and shall have power to

postpone events and give directions consistent with rules adopted for conducting any event.

- d) For IPC Competitions the entry criteria (number of athletes/NPC, MQS, list of events, etc.) shall be defined in the Qualification Documentation.
- e) In IPC Shooting Level 2 and Level 3 competitions an individual event is only viable if there are a minimum of four (4) participating countries in the start list by the final entries deadline. In IPC Shooting Level 1 competitions to be an approved event at least 3 countries need to be on the start list by the final entries deadline. IPC Shooting reserves the right to cancel any events which are not viable and inform the LOC in a timely manner.
- f) Regional Championships can also be organized as Open Regional Championships based on the viability of the events and following IPC Shooting approval. In case of Open Regional Championships there will be shot only one (1) final in each event with 8 finalists from the Open result list.
- g) The competitions can be split into Air and firearms competitions.
- h) For World, Regional Championships and World Cups IPC Shooting will agree with the Local Organizing Committee the number of entries per event based on the number of available firing points and time schedule.

2.4 Athletes Eligibility

- a) All competitors must adhere to the IPC Nationality Policy: IPC Handbook- Section 2 - Chapter 3.1 - IPC Athlete Nationality.
- b) At IPC Competitions, and sanctioned competitions all competitors shall be licensed by IPC Shooting in accordance with the IPC Athlete Licensing Policies.
- c) At IPC Competitions all athletes shall have international classification status of 'Confirmed' or 'Review' in accordance with the classification procedures and requirements laid down in the IPC Shooting Classification Manual.

2.5 Minimum Qualifying Standards

- a) The Minimum Qualifying Standards will be defined by IPC Shooting for IPC competitions and published in the Qualification Documentation. (Appendix 2).
- b) All shooters are required to reach the Minimum Qualifying Score (MQS) set to be eligible to compete in IPC Competitions.
- c) There are no required Minimum Qualifying Score (MQS) for competing in IPC Shooting sanctioned or approved Competitions.
- d) Minimum Qualifying Scores (MQS) will be verified by IPC Shooting.

3 COMPETITION PROCESSES (PRIOR, DURING, AFTER)

3.1 General

If the Athlete's IPC Shooting ID Card is lost a fee of 25€ will be charged for its replacement. As soon as the loss is realized by the athlete then they must contact their NPC and IPC Shooting office immediately.

3.2 Prior competition processes

3.2.1 Equipment Control

- Before the start of the competition, every athlete will have their equipment checked by the international Equipment control panel and have their equipment control sheet filled in. Random equipment checks will be done during or directly after a competition.
- Shooters must use only equipment and apparel that complies with the ISSF and IPC Shooting Rules. Anything (guns, devices, equipment, accessories, etc.) which may give a shooter an unfair advantage over others and which is not mentioned in these Rules, or which is contrary to the spirit of the ISSF and IPC Shooting Rules and Regulations, is prohibited. The shooter is responsible for submitting all equipment and apparel for official inspection and approval to an ISSF/IPC Shooting-supervised Equipment Control prior to its use in IPC Shooting competitions. Team leaders are equally responsible for ensuring that the shooters' equipment and apparel comply with the ISSF and IPC Shooting Rules and Regulations.

3.2.2 One-time-only Equipment Control

- All equipment and apparel may be inspected on a one-time only basis at an IPC World Championship or IPC World Cup "Paralympic Qualifier". Equipment Control certification must be retained with inspected equipment for presentation. Any inspected equipment or apparel that is changed must be re-inspected.
- If a shooters' equipment has not been passed by a "One time only" equipment control then the equipment is valid only for that competition.

3.2.3 International Classification

- International Classification will be executed prior to the start of the competition.

- The Chief Classifier of the competition will draft a list and timetable for athletes to present themselves for classification.
- Before the start of the technical meeting the classification processes must have been completed.

3.2.4 Technical Meeting

- Before the start of the competition there must be a technical meeting with representatives of the participating countries and the Organizing Committee, supervised by the IPC Shooting Technical Delegate or Chief Referee.
- In general ISSF rules are followed for this process except for the World Cups (or World Cup “Paralympic Qualifiers”) where the Technical meeting should be completed 12 hours prior the start of the first competition.

3.2.5 Start Number

- The start numbers are produced and distributed by the Local Organizing Committee.
- In case that the start number is available but not worn the athlete may not commence/continue to shoot in the event.
- The start number must be assigned to specific athletes and appear on all competition lists and timetables.
- The start number size and design must be as shown on the design in Appendix 3.

3.3 During competition processes

3.3.1 Technical Protests and Appeals

- Violation of the technical rules will be handled as per I.S.S.F./IPC Shooting rules.
- All protests, including appeals, regarding technical matters must be handled as per I.S.S.F. rules.
- The protest fee must be delivered to the Technical Delegate or Chief Referee. If the protest is upheld, the protest fee must be returned.
- If the protest is denied the protest fee will be retained by the IPC Shooting.
- The appropriate fee (as per ISSF) must accompany appeals.

- The decision of the Jury of Appeal is final.

3.3.2 Disqualification

An athlete, team official, team member or any other individual who:

- contravenes the spirit of fair-play offends manifestly members of any committee, officials or referees in the course of his/her official duties
- behaves himself/herself in a manner which discredits IPC Shooting, IPC, any International Federation or the Organizers of a competition may be penalized, according ISSF and IPC rules.

Situations that are not covered by the rulebook will be examined under a “case by case” basis by the IPC.

3.3.3 Tie breaking

- In case of tied scores, in the qualification round for more than 8 shooters with 600 those cases will be handled as follows:
- Re-rank them based on the number of inner 10s
- In case there is still a tie for the finals there will be conducted a Shoot-off.

3.4 After competition processes

3.4.1 Results

- Scoring procedures for all IPC Shooting events are followed as those are described in the ISSF rulebook.
- The result book must be submitted within 14 days of the end of Competition (signed off results and electronic version in excel format). In the results list must be included the IPC Shooting ID numbers of the athletes

3.4.2 Rankings

- IPC Shooting shall maintain world and regional rankings based on the results submitted by the LOCs from IPC Shooting recognized competitions.
- A ranking system will determine the best performing athlete per event per season based on a point system.

- Only athletes that are licensed, have a sport class status Review or Confirmed and reach the rankings cut-off standard for the relevant event will have their results recognized for ranking purposes.
- The cut-off standard in order for an athlete to be introduced in the ranking lists is the Minimum Qualification Score (MQS) for World Championships.
- Ranking points will be attributed depending on the level of competition and according to the following table. The scores that will be considered are from Level 3 plus the best one (ranking position for the athlete) from Level 1 and Level 2.

Level 1: International Approved Competitions

Level 2: World Cup Competitions

Level 3: Paralympic Games, World and Regional Championships

Rank	Level 3	Level 2	Level 1
1	50	30	15
2	45	25	13
3	41	22	11
4	37	19	9
5	34	17	7
6	31	15	5
7	28	13	4
8	25	11	3
9	21	9	2
10	18	7	1
11	15	6	
12	12	5	
13	10	4	
14	8	3	
15	6	2	

- Competitions of Level 2 and higher are automatically placed in the ranking system.
- Level 1 competitions need to apply for recognition in the system.
- Organizers need to use the electronic result sheets (excel format) supplied by IPC Shooting.

3.4.3 Tie breaking (for ranking purposes)

- In case of tied scores, in the qualification round for more than 8 shooters with 600 those cases will be handled as follows:
- Re-rank them based on the number of inner 10s

3.4.4 World and Regional Records

IPC Shooting will ratify World or Regional records which fulfil the below criteria:

- be Paralympic Games, World or Regional championships.
- be sanctioned by IPC Shooting World Cup or World Cup “Paralympic Qualifier”.
- be shot in accordance with the I.S.S.F. and IPC Shooting rules.
- all records are subject to doping control.

For sanctioning and record acknowledgement purpose, the Organizing Committee of a competition have to comply with the following conditions:

- all results and records achieved shall be forwarded to IPC Shooting office, for registration and maintenance of the records-book within two months after the competition.
- the form “Application for Shooting-record” must be submitted in time to the IPC Shooting office.

4 PROCESSES FOR APPROVAL AND SANCTIONING OF IPC SHOOTING COMPETITIONS

4.1 Process for International Approved IPC Shooting Competitions

For detailed process and minimum requirements refer to Appendix 4.

4.2 Process for World Cup (or Paralympic Qualifier) sanctioned IPC Shooting Competitions

For detailed process and minimum requirements refer to Appendix 5.

The World Cup programme can be as follows:

Programme 1: All events	R1-R8-(R9) / P1-P5 / (FT)
Programme 2: Air Events	R1-R5 / P1-P2-(P5) / (FT)
Programme 3: Firearm	R6-R8-(R9) / P3-P4

The events in the parenthesis are optional.

5 IPC SHOOTING OFFICIALS

5.1 General

For all IPC Shooting recognized competitions ISSF requirements in relation to Chief range officer and range officers apply.

For the requirements of Education, training, certification and professional development of IPC Shooting Officials see Referee's manual.

At IPC competitions, IPC Shooting shall appoint the Technical Delegate, and shall appoint or approve an appropriate minimum number of IPC Shooting officials to run the competition. The same referees are used to cover all below Juries and the Juries will be assigned by the Technical Delegate. The Jury of Appeal will consist of the Technical Delegate, one (1) IPC Shooting referee and one (1) referee from the host country appointed by IPC Shooting and is announced prior to the start of the competition:

- Jury of Appeal (2),
- Rifle Jury (2)
- Pistol Jury (2)
- Classification Jury: no extra IPC Shooting referee is required but 1 additional ISSF referee
- Equipment Jury (2 same Chairmen of Pistol and Rifle Juries)
- IPC Shooting Chief Classifier (1) and Classifiers (appropriate number) if applicable.

At sanctioned competitions IPC Shooting shall appoint the following minimum number of officials: 1 Technical Delegate, 1 Chief Referee, 2- 3 IPC Shooting referees (based on the event programme), and classification panel(s) if applicable.

For approved competitions IPC Shooting appoints 2- 3 IPC Shooting referees (based on the event programme), and classification panel(s). One of the above IPC Shooting referees will be appointed as Chief Referee.

For IPC competitions, and sanctioned competitions a Local Organizing Committee (LOC) shall be appointed by the responsible body to manage the competition. The LOC, in conjunction with the IPC Shooting shall be responsible for the entire management of the competition, including the arrangement of the programme of events, arrangement for the classification of shooters, all technical equipment and installation prior to and during competition. The structure of the LOC must be approved by IPC Shooting.

5.2 Duties and functions of Officials

5.2.1 Technical Delegate (TD)

The Technical Delegate shall be responsible to conduct site visits during the preparation period of the competition, check the Field Of Play (FOP) and ensure that the competition will run smoothly and according to the rules and regulations.

The Technical Delegate shall be responsible for the competition Field Of Play (FOP) and ensure that the competition is run smoothly and according to the rules and regulations.

The Technical Delegate is ultimately responsible for all technical matters of the competition.

The Technical Delegate is ultimately responsible for all IPC Shooting officials appointed.

The random allocation of shooters to firing points and relays may be done either by the drawing of the lots or with a computer programme suited to this purpose, under the supervision of the Technical Delegate.

When electronic scoring targets are used, targets must be checked for functioning and accuracy under the supervision of the Technical Delegate.

A report on newly established World or Paralympic records must be prepared by the IPC Shooting Technical Delegate at the end of the Championships/Games.

5.2.2 Referees

The duties and functions of the IPC Shooting Referees are as described in the IPC Shooting Referees manual.

5.2.3 Classification Panels

The duties and functions of the IPC Shooting Chief Classifier and Classifiers are as described in the IPC Shooting Classification Rules and Regulations.

5.3 Education, Certification and Development of Officials

5.3.1 General

IPC Shooting has developed specific pathways for the education and certification of the Technical Officials.

Only IPC Shooting can certify IPC Shooting Technical Officials at the various levels.

5.3.2 IPC Shooting Technical Officials Levels

The minimum qualification in order to become an IPC Shooting Technical Official is to hold a valid ISSF Judges "B" License.

a) Junior International Referee (C)

Qualification requirements

The successful completion of two (2) days referee workshop including the examination is required.

Following the successful completion a certificate will be sent by IPC Shooting.

Competency

Certified Junior International Referees may be allowed to attend an International approved competition accompanied by Senior International Referees.

b) Senior International Referee (B)

Qualification requirements

Certified Junior International referees can be upgraded to Senior International Referees by working under supervision for two (2) sanctioned shooting competitions under the supervision of an IPC Shooting Supervising Referee at their own expense.

The IPC Shooting Supervising Referee will submit to IPC Shooting the Evaluation of Performance / Progress Report of Approval after the sanctioned competitions.

The IPC Shooting officials who supervised the officiating work that the Junior International Referee did over the two (2) IPC Shooting competitions submit a letter of assessment to IPC Shooting.

Competency

Senior International Referees are competent to run World Cups.

c) Supervising Referee (A)

Qualification requirements

The basis for upgrading to the status IPC Shooting Supervisor Referee is the experience over a number of years acquired as Senior International Referee

- He/she must be an active Senior International Referee for at least four (4) years
- He/she must have the ISSF EST-License (Electronic-Scoring-Target-License)
- Must have attended at least on five (5) competitions level 2 or higher.

On at least two occasions the applicant must have been a Jury Member. The other three occasions must have been as a Chief Range Officer, Chairman of the Jury, Chairman of Classification or Chairman of Equipment Control.

IPC Shooting will decide on the upgrading applications at its annual meeting.

Competency

After the upgrade of the International IPC Shooting - License to IPC Shooting Supervisor Referee License he/she is responsible to write a report when working as Supervisor for every applicant which works under Supervision to the IPC Shooting Head of Officiating.

The referee allocation to competition will be based on the level of competency in relation to the weight of the competition.

d) Technical Delegate

The function of Technical Delegate can be fulfilled only by a Supervising Referee A.

6 SPECIAL CONDITIONS

6.1 Return to Field of Play Decisions

At sports venues, it is the responsibility of the team physician to determine whether an injured athlete may continue in or return to the competition. This decision should not be delegated to other professionals or personnel. In the absence of the competent physician, other professionals or personnel should adhere strictly to the instructions that he or she has provided. At all times, the overriding priority should be to safeguard the health and safety of athletes. The outcome of the competition should never influence such decisions.

6.2 Epilepsy

6.2.1 It is imperative from a safety perspective that epilepsy is stable and well controlled by medication. Therefore it is the duty of athletes and NPC/Team officials to inform the Technical Delegate of any athlete that has ever suffered any form of epileptic fit/seizure or epilepsy related episode. This will be done on an official Medical Information Form available from the TD or other competition officials.

6.2.2 The Medical Information Form must be completed and signed by a neurological doctor and must be handed over to the TD. The form must certify that the epilepsy is stable and identify what type of epilepsy the athlete suffers from. The certifying doctor must be able to verify that the athlete has not had a seizure for one year before the date of signing.

6.2.3 These Medical Information Forms must be delivered by the athlete to the TD before each competition. Failure to produce this form will result in the athlete not being allowed to shoot.

6.2.4 Athletes with epilepsy must always have a team representative near to them when they are shooting, who has assigned responsibility to observe the athlete and who is aware of their condition. This representative must be aware of the signs to look out for as indicating the onset of an epileptic episode and what to do in such an emergency.

6.2.5 The TD must be aware of the applicable national legislation relating to epilepsy and the use of firearms. It may be that athletes covered by this Chapter will not be able to compete in a Recognised Competition due to local laws regardless of whether they satisfy the above conditions.

7 IPC SHOOTING GENERAL RULES

7.1 Events and Programme of events

- IPC Shooting will select events for each competition from the following list of events:

(Note: The discipline names have been adjusted in order to be in accordance with the ISSF names. The adjustments appear in the below table. For disciplines that the name remained the same this appears only in the current name column).

Event	Discipline		Gender	Class
	Former Name	Current Name		
R1		10m Air rifle standing	Men	SH1
R2		10m Air rifle standing	Women	SH1
R3		10m Air rifle prone	Mixed	SH1
R4		10m Air rifle standing	Mixed	SH2
R5		10m Air rifle prone	Mixed	SH2
R6		50m Rifle prone	Mixed	SH1
R7	50m free Rifle 3x40	50m Rifle 3 positions	Men	SH1
R8	50m sport Rifle 3x20	50m Rifle 3 positions	Women	SH1
R9		50m Rifle prone	Mixed	SH2
FTR1		Falling Targets Rifle	Mixed	SH1
FTR2		Falling Targets Rifle	Mixed	SH2
P1		10m Air pistol	Men	SH1
P2		10m Air pistol	Women	SH1
P3	25m Sport Pistol	25m Pistol	Mixed	SH1
P4	50m Free Pistol	50m Pistol	Mixed	SH1
P5		10m Air Pistol Standard	Mixed	SH1
FTP		Falling Targets Pistol	Mixed	SH1

- The list of events for a competition may change until the final entry verification is closed.
- The programme of event shall not be modified.
- Only IPC Shooting is authorized to grant exceptions on the programme.

7.2 Equipment

7.2.1 General

- a) All equipment specific to IPC Shooting must conform to the following IPC Shooting standards. Shooters must use only equipment and apparel that complies with the ISSF rules/ IPC Shooting rules. Anything (guns, devices, equipment, accessories, etc) which may give a shooter an unfair advantage over others and which is not mentioned in these Rules, or which is contrary to the spirit of ISSF/IPC Shooting rules and regulations, is prohibited.
- b) The equipment used must be inspected and passed before the start of the competition as per the ISSF and IPC Shooting rules. A checklist as described in Appendix 6 shall be used as a record of the checking process.

7.2.2 Shooting Chairs

- a) For definition purposes, wheelchairs, stools, chairs and seats will be referred to as 'shooting chairs'.
- b) The measurement is done with shooting equipment, shoes, gear and measured in sitting position.
- c) All shooting chairs will be checked with the shooter in the shooting position during the equipment control and will be subject to spot checks on the shooting line before, during or immediately after the competition. Athletes must not add any material or modify the structure of their chairs to gain stability of the pelvis of the spine and thus gain unfair advantage against their fellow competitors. Under special circumstances the functional classification panel may allow a special backrest to overcome a specific physiological condition of the spine.
- d) In all standing events, the arms and sideboards of the shooting chair and the shooting table must be removed. If the construction of the wheelchair requires a sideboard, the height of this may not exceed the height of the top of the wheel. In kneeling events, the arm(s) of the shooting chair, which are not used to attach the table/board to, must be removed. In prone and kneeling positions the arms of the shooting chair are a part of the shooting table.
- e) No part of the backrest of any shooting chair will be permitted to exceed the maximum height laid down in these rules, including and especially the vertical side posts of the backrest. (see picture below)

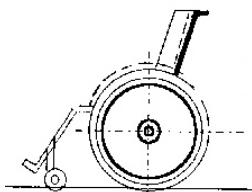

Handles and side posts may not exceed height of backrest.

- f) No part of the backrest may be higher than the maximum height allowed by the shooter's classification.
- g) The maximum slack (stretch) of the fabric of the backrest, that is the distance from the front of the vertical side posts of the backrest to the deepest part of the backrest, shall not exceed 8 cm. This is to be measured with the shooter in the chair in the shooting position. (see picture below)

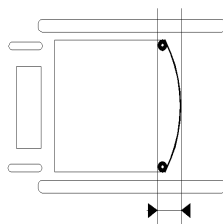

Slack < 8cm

- h) For sitting shooters in class SH1A and SH2A who are not shooting from a wheelchair must use a high shooting chair suited to his/her height.
- The sitting angle is unlimited.
 - The angle of the surface of the seat of the shooting chair is allowed up to 5 degrees from horizontal.
 - The chair may be upholstered with material compressible up to a maximum of 5 cm.
 - The shooter must be able to remove their feet off the floor, without losing balance and without moving the upper body (see also point 6.2.1b).
- i) Shooters and their equipment must be within the designated size of their firing point.
- j) The centreline of the barrel in case of sitting competitors must not exceed more than 150 cm, measured from the ground or floor. IPC Shooting can decide, to allow different heights, due to certain circumstances.
- k) The sitting angle and backrest angle is free.
- l) For class SH1B & SH2B shooters a minimum of 60% of the total back length of the shooter need to be above the backrest. The length of the spine is measured in vertical position from the surface on which the shooter is sitting, along the contour of the spine to the middle of vertebra C7 (vertebra prominence). The measurement will be done during functional classification without shooting gear.

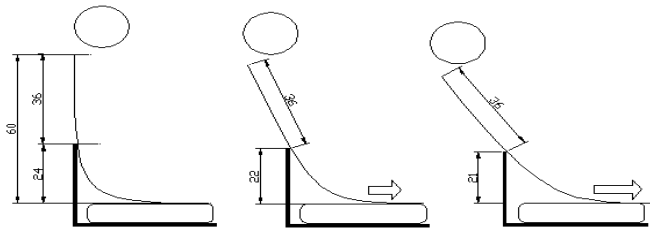

- m) For class SH1C & SH2C shooters the length measured from C7 until 10 cm under the armpits (axilla), at the rifle supporting side for rifle shooters and the side of the shooting arm for pistol shooters, needs to be free above the backrest. (see picture)

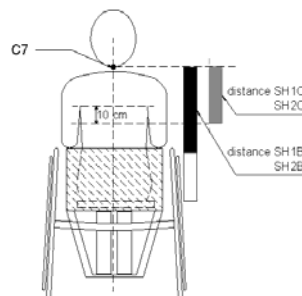

- n) The minimum length of back above the backrest will be marked on the IPC Shooting ID card.
- o) The minimum length of back above the backrest will be marked on the shooting jacket (as a reference only) in the centre of the back and the mark must be visible at all times.
- p) For SH1A and SH2A shooters, a back-support of any height may be fitted to the shooting chair in such a way that competitors may take a rest against it between shots. However there must be clearly no contact between shooter and back-support when firing.
- q) Sitting competitors in class SH1A and SH2A may choose to stand. If so they must stand free of any artificial support with the exception of medically certified normal prosthesis/ orthosis.
- r) A shooting chair will be supplied by the competitor.
- s) Strapping to wheelchairs: it is permitted to have 1 below knee strap to the chair and the legs may be strapped together once above the knees but not to the chair. It is not allowed to hold or touch straps to gain stability. In the case of double above-knee amputees a strap across the stumps and strapped to the chair is permitted. Straps must not exceed 5 cm in width.

- t) All parts of the shooters equipment or body, which make contact with the floor or ground, must be behind the firing line.

7.2.3 Shooting Tables

- a) Shooting tables for sitting classes may be attached to the shooting chair or may be free standing. A small upstanding edge to prevent small items from falling may be fitted but in no way shall it be used for additional stability or support of the shooter.

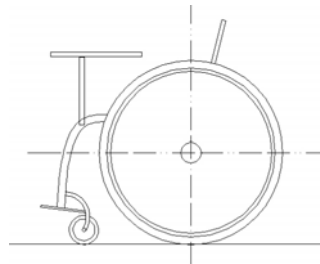
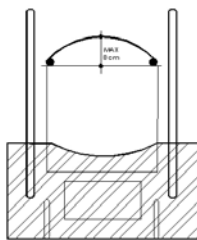

- b) The shooting table must be horizontal or at the same angle as the floor, measured at the centre of the table. A variation of ± 5 degrees is allowed.
- c) In rifle shooting the table or board may be upholstered with compressible material of a maximum thickness of 2 cm. Other material on the table must be of uniform thickness for both elbows. It is not permitted to make a hollow in the table or board or in the upholstered material.
- d) If required because of uneven arm length or similar problem, a compensating block may be used, but this fact must be authorized by the functional classification panel and marked on the classification card.
- e) The maximum surface for support of the elbow in kneeling position is 10 cm in diameter.
- f) If a large table is used in the kneeling position, a removable board with a diameter of 10 cm and a thickness of at least 20 mm must be attached to this table fixed at the full board. (see picture below).

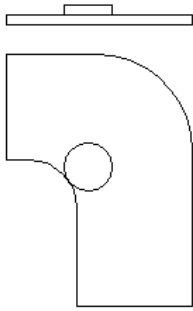

- g) The table, if fitted, must not be used to gain support or stability for the body in any way, except for prone position(not allowed to gain stability on the left or right side of the chair with the abdomen). A separate board or table may be allowed for the shooting stand.

7.2.4 Shooting Jackets

- a) The maximum length of the shooting jacket may not be longer than down to the lap in front and down to the top of the cushion in back, in case of sitting competitors. The length of the jacket will be measured in standing shooting position.

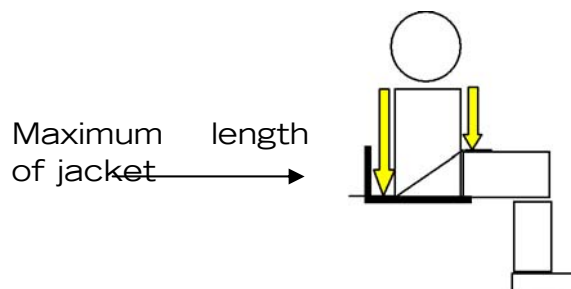

- b) Maximum length of the jacket.
For SH1A and SH2A shooters an ordinary jacket as prescribed by ISSF is allowed in case they shoot from a high stool or free standing. No competitors are allowed to sit on their shooting jackets during competition. When shooting from a wheelchair, rule 7.2.4 a) applies.
- c) The same shooting jacket may be used in all shooting positions. Only one shooting jacket may be approved by equipment control for each shooter for all rifle events in one competition.
- d) An exception to the above rule is made for SH1/SH2 athletes in the following cases:
- shooting the prone position lying on the floor or table
 - shooting the kneeling position from a standard shooting chair
 - in air rifle prone events competitors may not lay down, but must use a table and a shooting chair. If the athlete has to use a table he or she must also use a shooting chair.

- shooting Air Rifle prone from a standard shooting chair.

In these cases it is allowed to use an ISSF regulated jacket in this position only.

7.2.5 Shooting Trousers

- a) Shooting trousers are prohibited for sitting competitors.
- b) For SH1A shooters shooting trousers as prescribed by ISSF is allowed in case they shoot from a high stool or free standing.
- c) For definition of the shooting trousers, refer to ISSF rules.
- d) Trousers made of canvas fabric (jeans) are allowed in all levels of IPC Shooting competitions, except for the Paralympic Games.

7.2.6 Orthopaedic boots

Orthopaedic boots are individually prescribed and fashioned footwear used all day in daily life to enable the individual's medical condition. It must be checked and recorded at classification if this footwear may be used in competition.

7.3 Specifications class SH1

These groupings of disabilities are to be used as a guide only and the classification panel can assess each case in their full shooting equipment in the shooting positions.

- Class SH 1 A

Sitting competitors who are able to stand and have normal trunk functions. No backrest is allowed on the shooting chair. These competitors may choose to stand to compete if they wish.

- Class SH 1 B

Sitting competitors who have non-functional lower limbs or severe problems in lower limbs and have good pelvis control (functional abdominal/spinal extensors, m.quadratus lumborum). A low backrest is allowed on the shooting chair.

- Class SH 1 C

Sitting competitors with non-functional lower limbs or severe problems in lower limbs and fair/none trunk functions. A high backrest is allowed on the shooting chair.

- a) All competitors in class SH1 will compete in the same class; the subclasses are only to define the backrest height according to their classification.
- b) Sitting competitors in class SH1A may choose to stand, but if so they must stand free of any artificial support with the exception of medically certified normal prosthesis/orthosis.
- c) In the case of SH1 arm-amputee shooters, it is allowed to hold the rifle with a normal prosthesis, as long as the prosthesis does not grip the rifle and does not have a fixed elbow. In this case shooter shoots as SH1, with no loader.
- d) If standing in SH1A, all shooting positions will be shot as described in the I.S.S.F. rules with the following exceptions:
 - 1. In 50m rifle prone position a shooting chair is allowed.
 - 2. In the kneeling position of the three position events a stool of 350 mm. maximum height can be used if marked on the classification card (note that the stool is to support the leg and not to sit on it). If a shooting chair and table is used, the competitor must comply with all rules regarding the use of shooting chairs and tables in kneeling positions.
 - 3. In air rifle prone events competitors may not lay down, but must use a table . If the athlete has to use a table he/she must also use a shooting chair.
- e) In the standing position from a shooting chair the rifle must be held with the arms only, without support (as per I.S.S.F.). No part of the arms may come in contact with any part of the shooting chair. Not any part of the elbows is to make contact with the lap, wheel or gain support other than from the ribcage, hip or abdomen.
- f) In the kneeling position from a shooting chair or stool, or standing at a table, only one elbow must rest on the table or board and the body must be well clear of the board. No support may be gained from the board/table frame.
- g) In the kneeling position from a chair or stool, the supporting forearm must form an angle of not less than 30 degrees from the horizontal. Only the point of the elbow may be supported on the 10 cm block.
- h) In prone shooting, both elbows (not upper arms) must rest on the table or board. The forearm in this position must not form an angle of less than 30 degrees from the horizontal, measured from the axis of the forearm. The chest and/or abdomen may rest on the board or table.

- i) In all standing events, the arms and sideboards of the shooting chair and the shooting table must be removed.
- j) If the construction of the wheelchair requires a sideboard, the height of this may not exceed the height of the top of the wheel.
- k) In kneeling events, the arm(s) of the shooting chair, which are not used to attach the table/board to, must be removed. In prone and kneeling positions the arms of the shooting chair are a part of the shooting table.
- l) The use of a loading assistant is permitted if sanctioned by classification.
- m) In case a loading assistant is used, refer to IPC Shooting rules and regulations. In standing and prone position, the shooter must clearly and visibly deshoulder between shots.

7.4 Specifications class SH2

- a) Rifle competitors who have measurable and /or visible permanent disability in upper limbs and therefore are unable to support the weight of a rifle for the purpose of the competitions with their upper limbs and require a shooting stand.
- b) These groupings of disabilities are to be used as a guide only and the classification panel can assess each case in their full shooting equipment in the shooting positions.

- **Class SH 2 A**

Sitting competitors who have one non-functional upper limb or severe problems with both upper limbs and have normal trunk functions. No backrest is allowed on the shooting chair. These competitors may choose to stand to compete if they wish.

- **Class SH 2 B**

Sitting competitors who have non-functional lower limbs or severe problems in lower limbs and have good pelvis control. A low backrest is allowed on the shooting chair.

- **Class SH 2 C**

Sitting competitors who have non-functional lower limbs or severe problems in lower limbs and have fair/none trunk functions. A high backrest is allowed on the shooting chair.

Note: The high backrest is up to 10 cm below the armpits.

- a) All competitors in class SH2 will compete in the same class; the subclasses are only to define the backrest height and the spring flexibility according to the classification.
- b) All competitors Class SH2 will compete in the same class and will use an approved support stand (see Appendix 7) to support the weight of the rifle. No other support or mechanical devices may be used as a support for the rifle. The shooting stand may be fixed to the table or on a tripod.
- c) The support stand, this is the top part (80 mm pin and rifle holder - total weight less than 200 gr), spring must be an official IPC Shooting approved model. The measurement will be done according to Appendix 7.
- d) It is allowed to shorten the bottom part of the support stand. The remaining length needs to be at least 40 mm, so that it will be possible to check the flexibility of the support stand during equipment control.
- e) The combination of balance, disability and arm/finger strength and function will determine which spring the shooter shall use and will be assessed at the classification.

SPRING CHARACTERISTICS	SUBCLASS
WEAK SPRING (white plastic part) = flexibility minimum 35mm	SH2Aa
	SH2Ba
	SH2Ca
STRONG SPRING (black plastic part) = flexibility minimum 25mm	SH2Ab
	SH2Bb
	SH2Cb

- f) The rifle may not contact both sides of the yoke at the same time.
- g) The yoke (rifle holder) must be at least 1 cm wider than the width of the rifle stock.
- h) The pin and the spring of the shooting stand must be in vertical position, front to back.
- i) It is allowed to add material inside the yoke as long as it is comparable to the surface of a shooting glove and it doesn't interfere with the measurements of the yoke.
- j) Sitting competitors in class SH2A may choose to stand, but if so they must stand free of any artificial support with the exception of medically certified normal prosthesis/orthosis.

- k) In case of SH2 arm-amputee shooters it is not allowed to hold (touch) the rifle with the prosthesis in standing position.
- l) In prone position it is allowed to hold the rifle with a normal prosthesis that does not grip the rifle or have a fixed elbow. Shooter shoots as SH2 and may have a loader.
- m) No device or substance may be attached to the rifle or the shooting stand in order to hold the rifle in a fixed position in, or against the shooting stand. The hands must not interfere with the operation of the spring when firing a shot. They must not be placed in front of the spring.
- n) In all SH2 shooting positions the use of a sling is prohibited.
- o) A SH2 shooter is allowed to add material that gives increased grip for the hands on the rifle, and on the butt plate to increase the grip on the jacket. The rifle needs to remain within the specified dimensions.
- p) The point of balance of the rifle must be marked at equipment check. The rifle must be placed +/- 5 cm of its point of balance on the rifle support stand and the total 10 cm range must be marked. The complete yoke must be within the 10 cm range.
- q) In case of gas or compressed air rifles, the point of balance will be measured with full containers.
- r) In the standing position all shooters must clearly and visibly deshoulder the rifle in between shots.

7.5 Specifications class SH3

This section is to be completed at a later stage if and when a classification system is compliant with the Classification Code and agreed by IPC.

7.6 Sport Equipment Dimensions

The plans and exact dimensions of the Sport equipment are available on Appendix 7.

7.7 Athlete's target changers for classes SH1 and/or SH2

- a) Target changers may be allowed for all athletes if required depending on the environment of the shooting range (e.g. paper targets) and is the decision of the Chief Referee, Chief Classifier and Range Officer.
- b) The target-changer must not speak or give signals during the match. He/she may only change targets.
- c) The target-changer must be at least 1 m behind the competitor between shots. Exceptions can be made at the discretion of the Jury.
- d) The target-changer must be dressed according to the ISSF rules (dress code)

7.8 Athlete's Loading Assistants for class SH2

- a) Competitors may be allowed to have a loading-assistant if necessary.
- b) Loading assistants are allowed only as described in the IPC Shooting classification rules and refers only to SH2 shooters competing in SH2 events.
- c) The decision to be allowed a loading-assistant can only be made by the classification panel and will be marked on the classification form and the IPC Shooting ID card.
- d) The loading-assistant must not speak or give signals during the match. He/she may only load the rifle and/or adjust the sights at the request of the shooter.
- e) The loading-assistant must be at least 1 m behind the competitor between shots. Exceptions can be made at the discretion of the Jury.
- f) Coaches are permitted to approach the line on request of the shooter if permitted by the range official.
- g) The loading-assistant must be dressed according to the ISSF rules (dress code).

8 IPC SHOOTING RIFLE RULES

8.1 Rifle Events and shooting times

- a) All shooting times are according to ISSF and IPC rules.
- b) IPC Shooting recognized competitions can comprise out of the following rifle events:

Event	Discipline			Gender	Class	Shots	Time	PG* WCPQ*	WCH* RCH*	All other competitions
R1	10m	Air	rifle	Men	SH1	60	1:45	X	X	X
R2	10m	Air	rifle	Women	SH1	40	1:15	X	X	X
R3	10m	Air rifle prone		Mixed	SH1	60	1:30	X	X	X
R4	10m	Air	rifle	Mixed	SH2	60	1:45	X	X	X
R5	10m	Air rifle prone		Mixed	SH2	60	1:30	X	X	X
R6	50m	Rifle prone		Mixed	SH1	60	1:30	X	X	X
R7	50m	Rifle 3 positions		Men	SH1	40 prone 40 standing 40 kneeling	1:00 1:30 1:15	X	X	X
R8	50m	Rifle 3 positions		Women	SH1	20 prone 20 standing 20 kneeling	2:30	X	X	X
R9	50m	Rifle prone		Mixed	SH2	60	1:30			X

PG*: Paralympic Games, WCPQ*: World Cup Paralympic Qualifier, WCH*: World Championships, RCH*: Regional Championships

- c) All above shooting times are valid for pit operated competitions or target carriers.

d) When electronic target systems are used the shooting times are as follows:

Event	Discipline	Gender	Class	Shots	Time
R1	10m Air rifle standing	Men	SH1	60	1:45
R2	10m Air rifle standing	Women	SH1	40	1:15
R3	10m Air rifle prone	Mixed	SH1	60	1:15
R4	10m Air rifle standing	Mixed	SH2	60	1:45
R5	10m Air rifle prone	Mixed	SH2	60	1:15
R6	50m Rifle prone	Mixed	SH1	60	1:15
R7	50m Rifle 3 positions	Men	SH1	40 prone	0:45
				40 standing	1:15
				40 kneeling	1:00
R8	50m Rifle 3 positions	Women	SH1	20 prone	2:15
				20 standing	
				20 kneeling	
R9	50m Rifle prone	Mixed	SH2	60	1:15

e) It is recommended that in 50m Rifle 3 positions competitions, at least every third firing point is left empty to ensure position changes without disturbing other shooters during the round.

9 IPC SHOOTING PISTOL RULES

9.1 Pistol Events and shooting times

a) IPC Shooting recognized competitions can comprise out of the following pistol events:

Event	Discipline			Gender	Class	Shots	Time	PG WCPQ	WCH RCH	All other competitions
P1	10m	Air	pistol	Men	SH1	60	1:45	X	X	X
P2	10m	Air	pistol	Women	SH1	40	1:15	X	X	X
P3	25m Pistol			Mixed	SH1	60		X	X	X
P4	50m Pistol			Mixed	SH1	60	2:00	X	X	X
P5	10m	Air	Pistol Standard	Mixed	SH1	40			X	X

b) All shooting times are according to ISSF and IPC rules.

c) The event P5 is shot according to the ISSF rules on one stationary air pistol target. No final is shot in this event.

d) P3 event is to be shot with Rim fire pistol according to ISSF rules.

e) P5 event is to be shot with 10m Air pistol standard according to ISSF rules.

9.2 Loading device (safety)

a) In general terms loading safety must follow the ISSF rules (6.2).

b) A device to hold the pistol to enable it to be loaded or unloaded safely by hand/arm amputee must be used at all times on the range with the range official's approval.

c) The loading device will be checked at equipment control by IPC Shooting referee to ensure safe handling.

9.3 Shooting position

In pistol shooting, the non-shooting arm/hand must not be on the shooting chair.



10 RULES FOR SHOOTING FOR VISUALY IMPAIRED ATHLETES

This section is to be completed at a later stage if and when a classification system is compliant with the Classification Code and agreed by IPC.

11 FALLING TARGETS RULES

11.1 Competition Format

- a) The competition is run as a pool competition. Each pool consists out of maximum 4 shooters that will compete against each other. The 2 best results go to the following round.
- b) The composition of the different pools is based upon the ranking lists in the events R1, R2, R4 and P1 and P2 of the latest published version of IPC Shooting rankings month prior to the competition. The first ranked athlete will start in pool 1; the second ranked athlete in the last pool. The third athlete starts in pool 2. All the other start places are assigned according the same system. Refer to Appendix 8
- c) The competition is shot as a separate event for Rifle SH1, Rifle SH2 and Pistol SH1.
- d) In rifle the competition is shot in the standing position.
- e) The weapon is a standard air rifle or pistol.
- f) The targets are biathlon-type targets with 5 sights and the number of firing points to run the competition is 4.
- g) Every phase of the pool is shot over 2 rounds of 5 shots with a time limit of 2 minutes 30 seconds.
- h) The size of the inserts is as follows (from left to right):
 - i) Air Rifle: 6mm – 6mm – 5mm – 5 mm – 4 mm
 - j) Air Pistol: 24 mm – 24 mm – 16 mm – 16 mm – 11 mm

11.2 Competition Commands

11.2.1 Preparation Time

Shooters must have 5 minutes before the competition starts their final preparation including sighting shots including in the final.

When all shooter have shot their first round the preparation time for the next second rounds will be 3 minutes.

11.2.2 *Commands*

The commands for the competition are as follows:

Commands	Explanation
Preparation Time start now	Start 5 or 3 minutes
30 seconds	After 4:30min or 2:30min
STOP	End of preparation time
Change Targets and take out 5 pellets	
For the first/next competition series LOAD	
ATTENTION, START	Start 1 st round
STOP	After 2:30min
Results announcement	
Change Targets and take out 5 pellets	
ATTENTION, START	Start 2 nd round
STOP	After 2:30min
Results announcement	

11.3 Results

- a) After each series of 5 shots the fallen targets of each group must be counted, announced to the shooter and recorded in the score card.
- b) If a shooter fails to shoot within the allowed time limit, the shot(s) is counted as zero.
- c) In case of equality a shoot-off on the extreme right target will determine the winner.
- d) In case of a rifle: after 3 attempts on the extreme right target without decision attempts to next larger size target (from Right to Left) and so on.
- e) In case of a rifle: after 3 successful attempts on the extreme right target, times for the shoot-off change from 30 seconds to 20 seconds.
- f) In case of pistol shooters we use the extreme left target and after 3 attempts without decision the shoot off time changes from 30 seconds to 20 seconds.

12 TEAM COMPETITION

- a) There will be team competitions in each event (except Falling Targets) as numbers permit except for the Paralympic Games (as per I.S.S.F.).
- b) All teams must consist of three (3) competitors.
- c) In competitions in level 1, two teams per country are allowed in each event.
- d) In all IPC Shooting recognized competitions, only one team per country is allowed in each event.
- e) To have team-competition in an event, at least four teams must be on the start list of that event after the final entries deadline, otherwise the event is automatically cancelled.
- f) Team scores will be shot concurrently with the individual scores, i.e. no separate team matches will be shot.
- g) Medals will be presented in team events as per regulations of ISSF and/or IPC (3 gold, 3 silver and 3 bronze medals).



International Paralympic Committee

Adenauerallee 212-214
53113 Bonn, Germany

Tel. +49-228-2097-200
Fax. +49-228-2097-209

E-mail: info@paralympic.org
www.paralympic.org
www.ParalympicSport.TV